

4k & 8k EXPERIENTIAL, IMMERSIVE LED DOME

elport
DIGITAL



1. Project Information
2. Design Scheme
3. Installation Structure
4. Cabinet & Accessories
5. Packing
6. Installation Precautions

1. Project Information

- Half of a 4m diameter sphere, with an opening of 1509mm

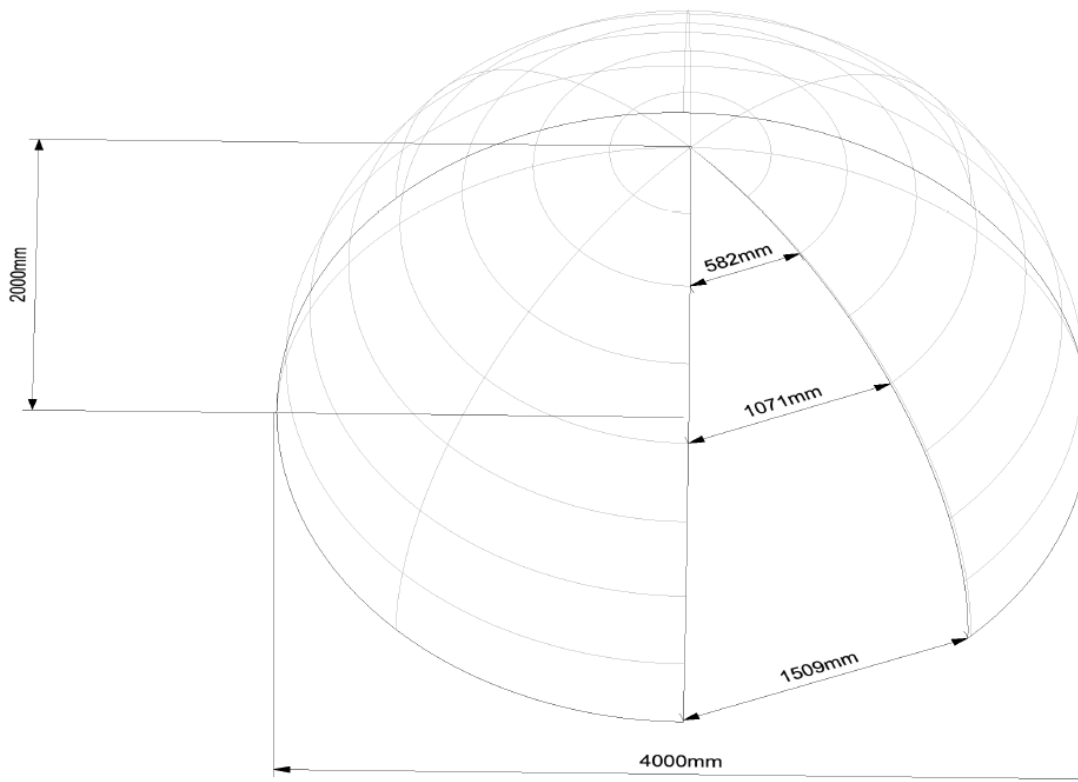

1. Project Information cont.

- Partial sphere, 4m diameter, 2m high

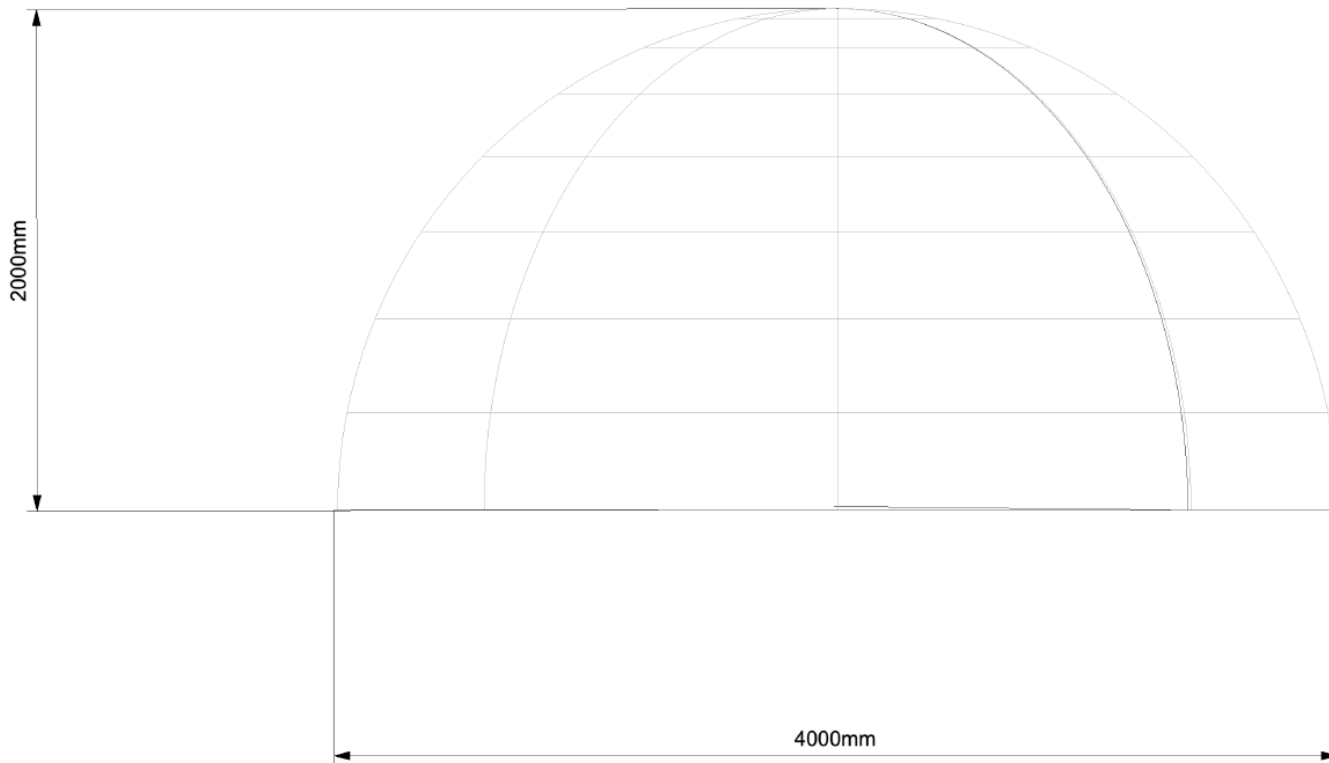

2. Design Scheme

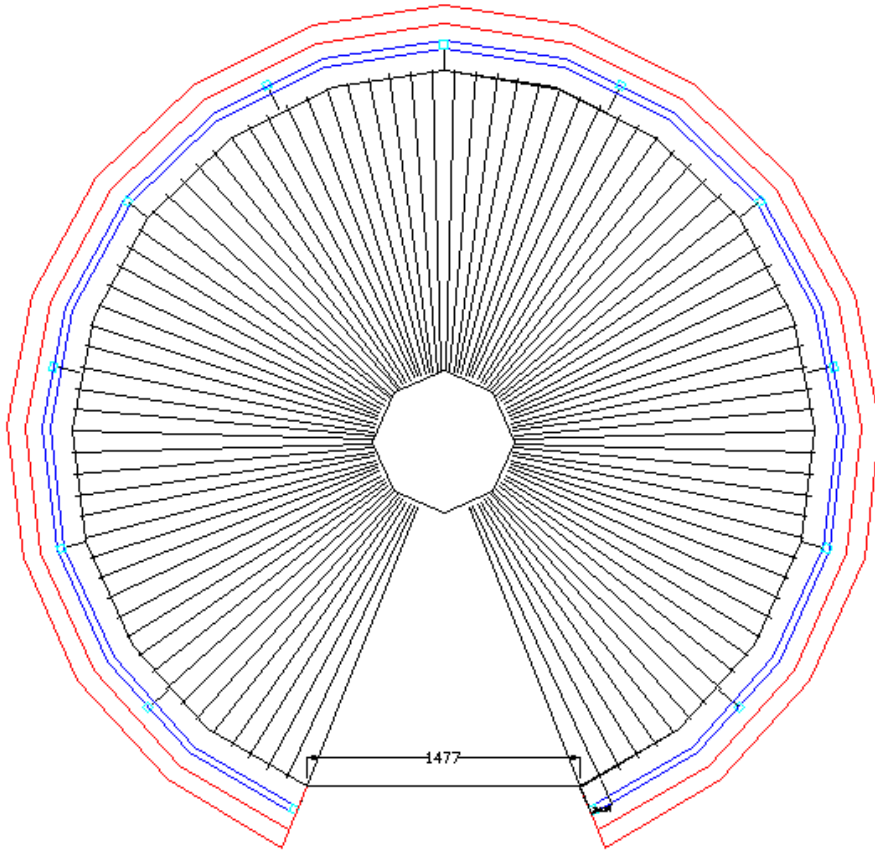

2. Design Solutions

- Module sizes (1)

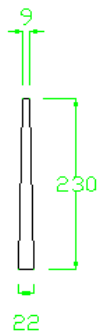

NO.01

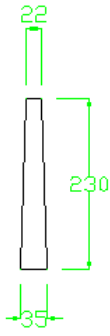

NO.02

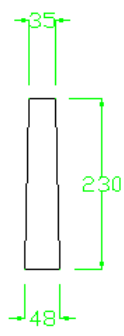

NO.03

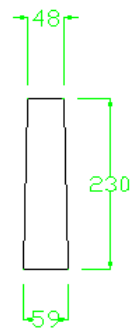

NO.04

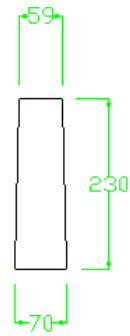

NO.05

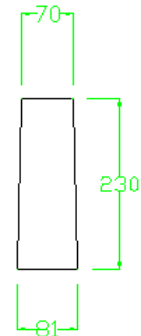

NO.06

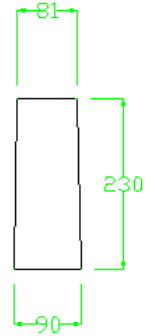

NO.07

2. Design Scheme

- Module sizes (2)

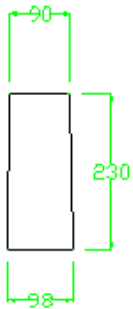

NO.08

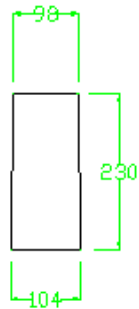

NO.09

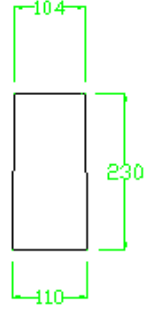

NO.10

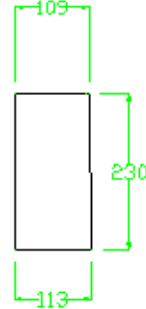

NO.11

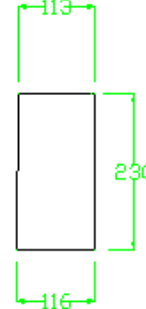

NO.12

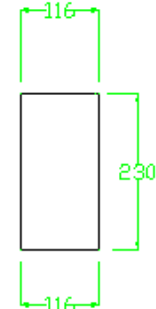

NO.13

2. Design Scheme

- Installation sketch

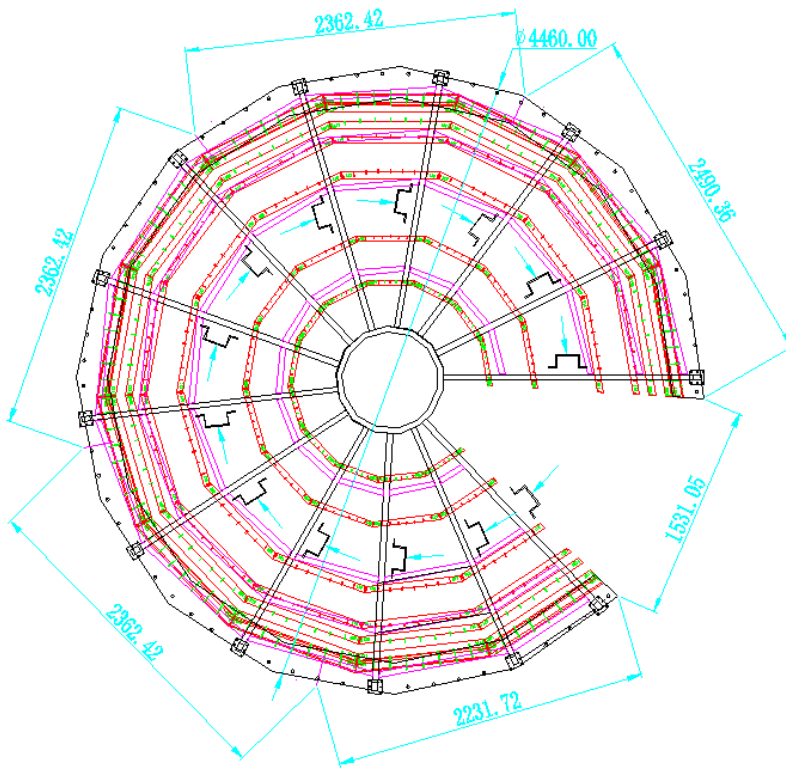

2. Design Scheme cont.

- Installation sketch

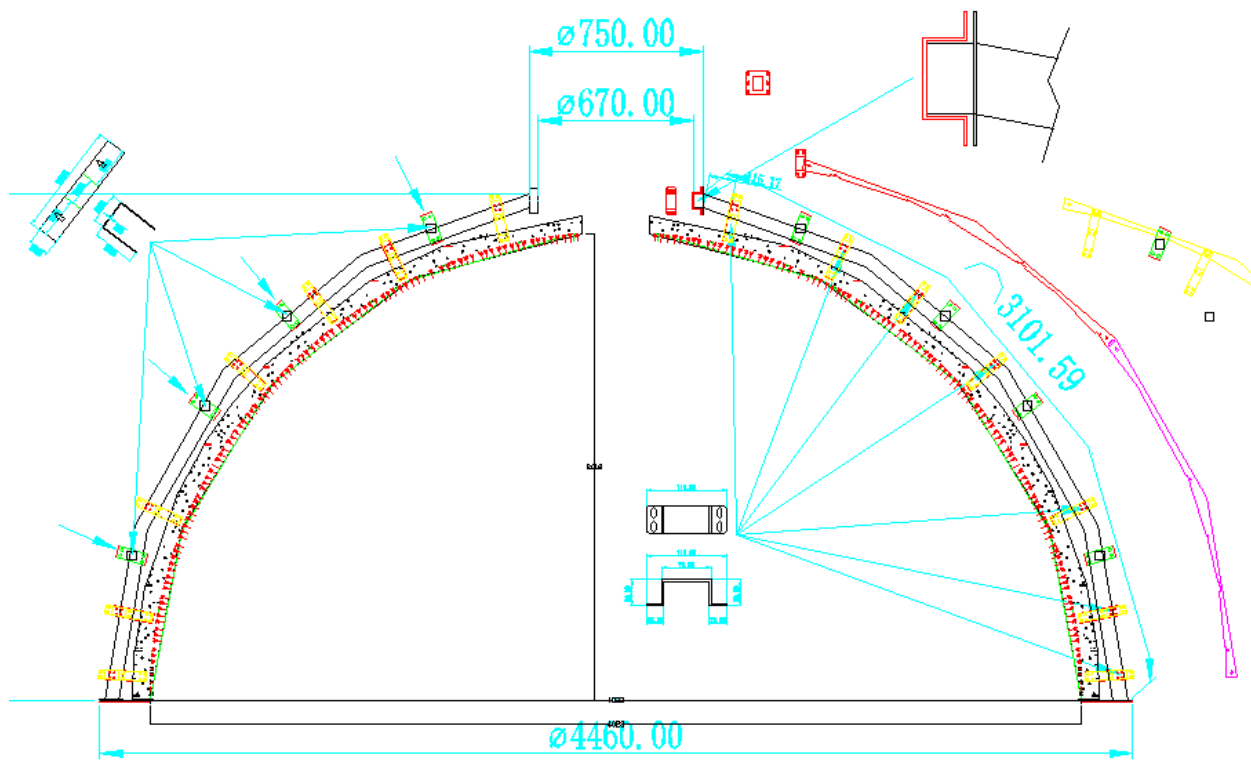

2. Design Scheme cont.

- Power connection diagram

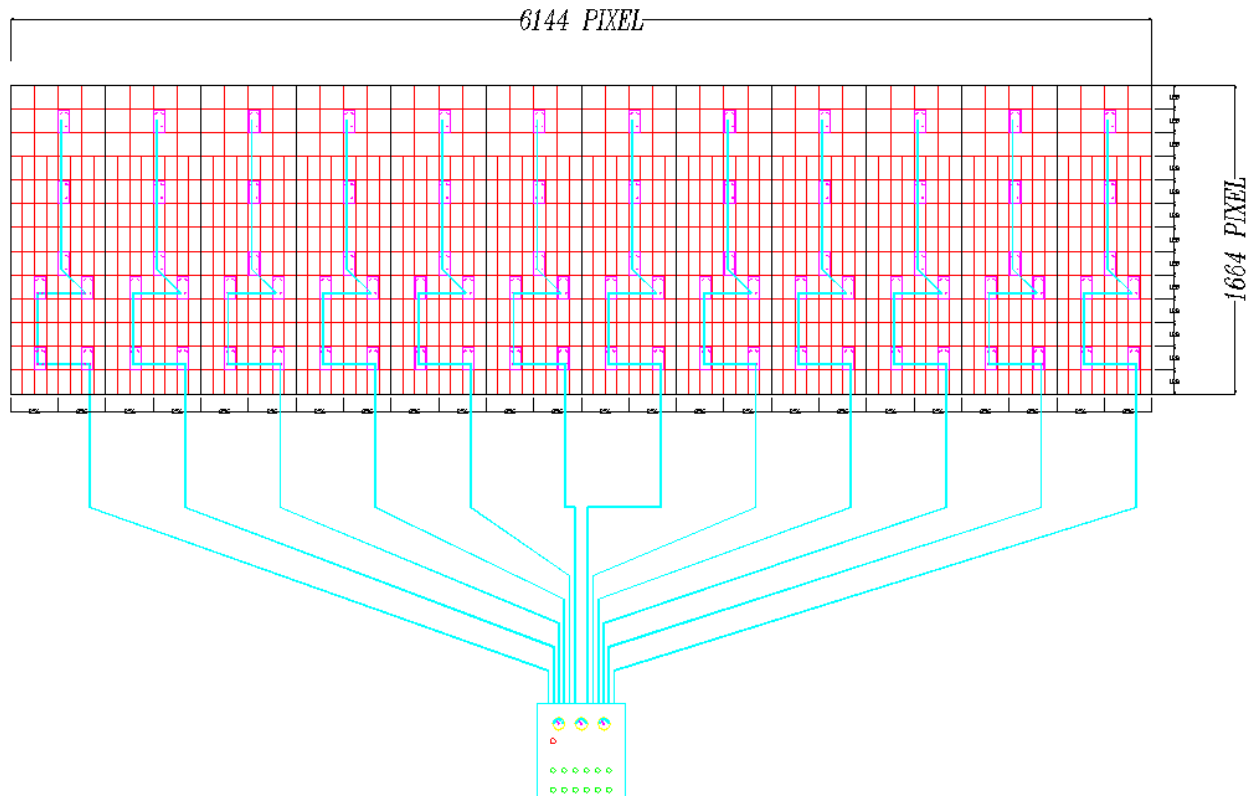

2. Design Scheme cont.

- Control system connection diagram

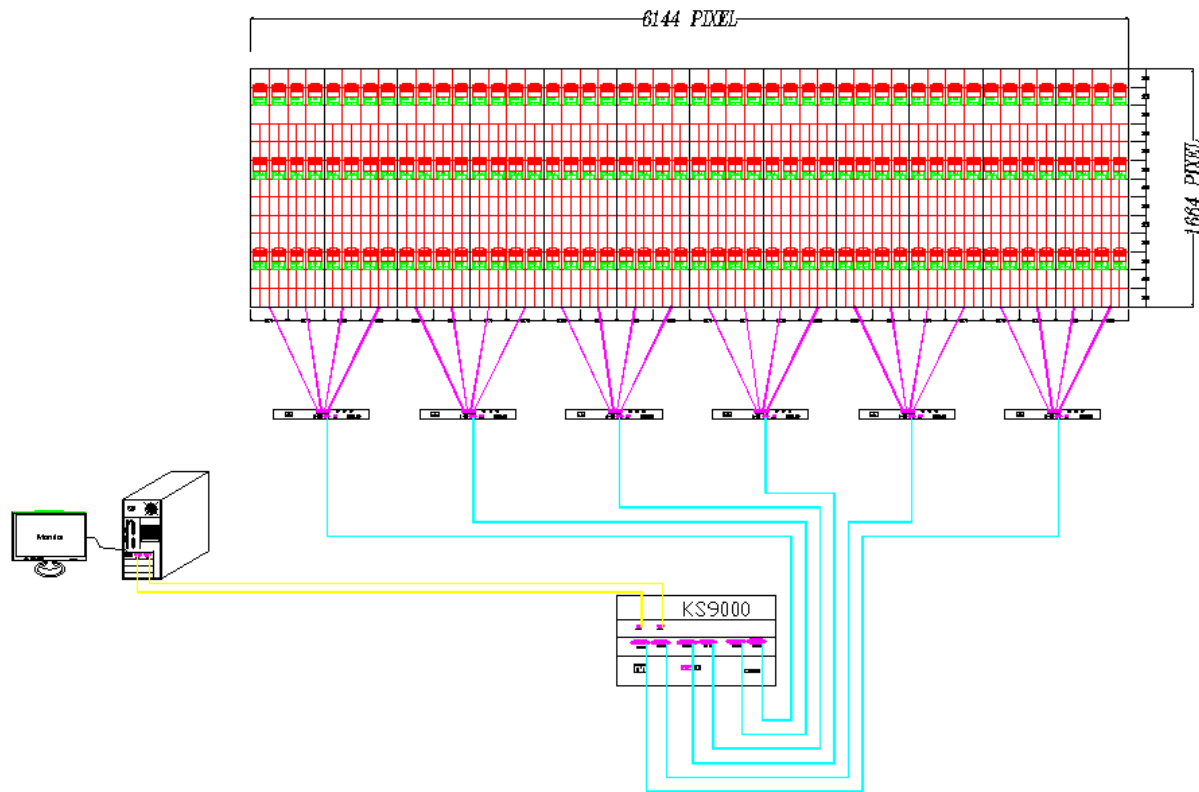

3. Installation Structure

- Installation structure assembly

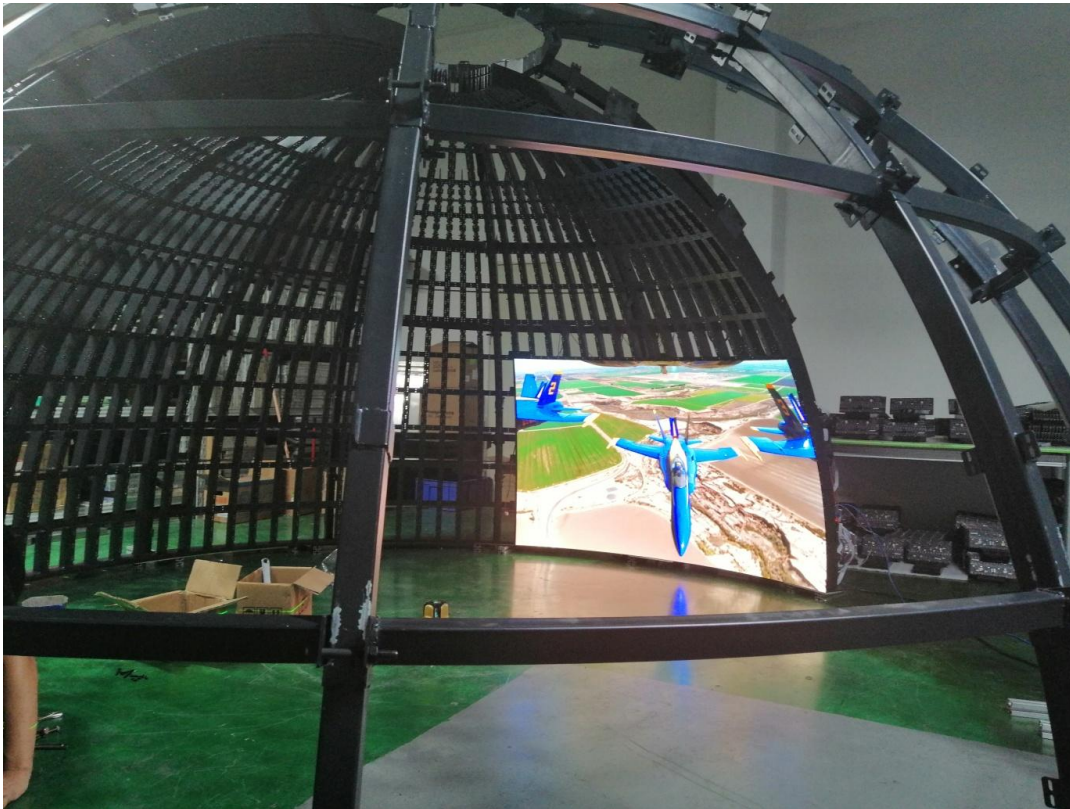

3. Installation Structure cont.

- Structure assembly

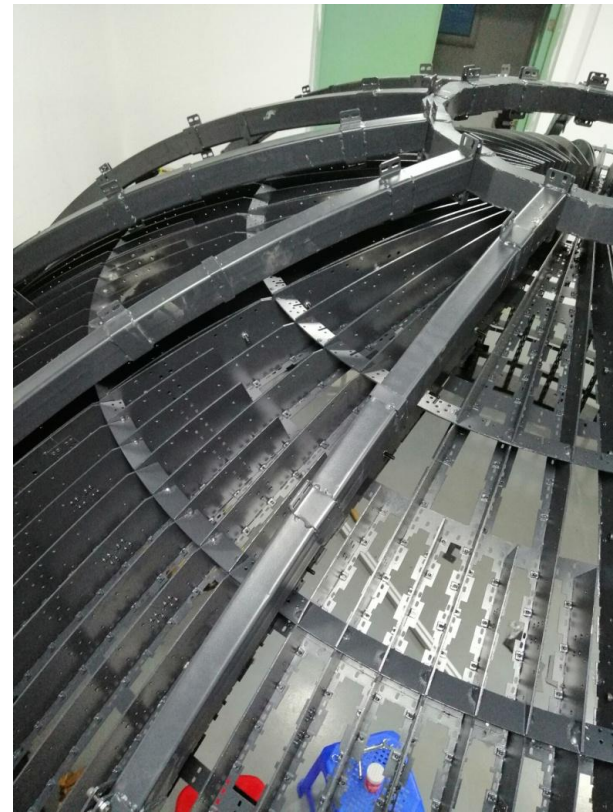

3. Installation Structure cont.

- Cabinet assembled to structure



4. Cabinet & Accessories

- Cabinet in production

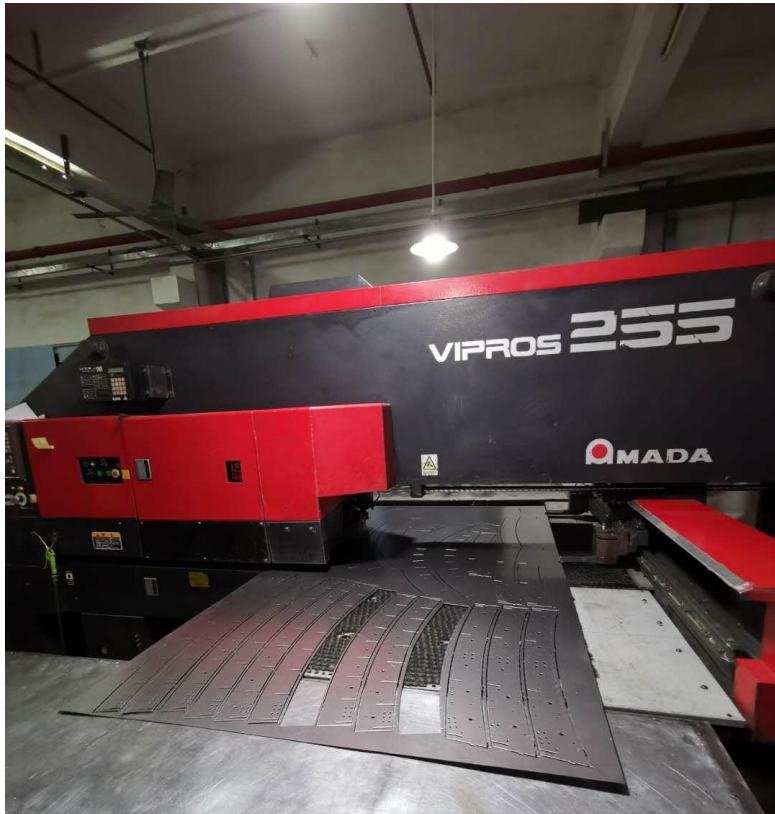

4. Cabinet & Accessories cont.

- Cabinet



4. Cabinet & Accessories cont.

- Cabinet assembly

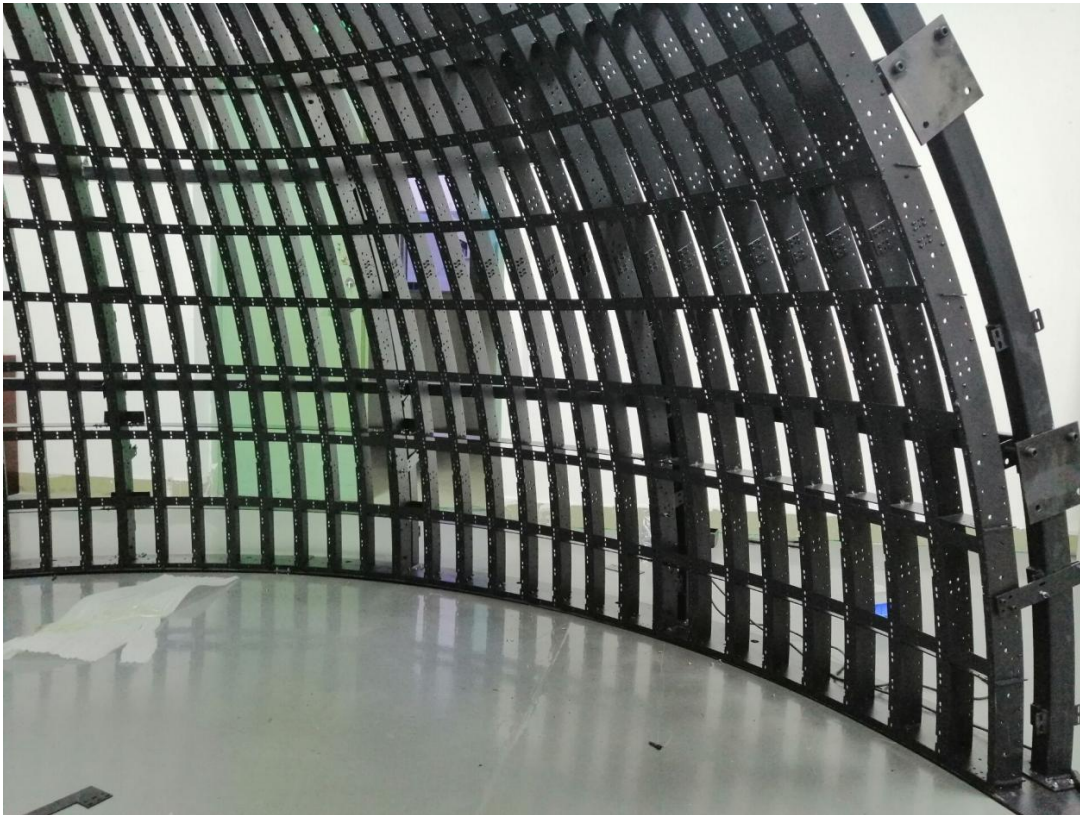

4. Cabinet & Accessories cont.

- Module molding boards

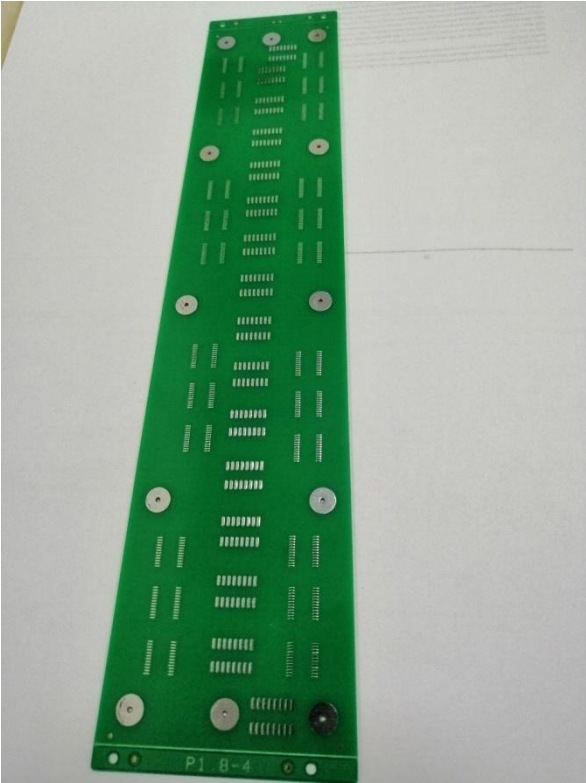
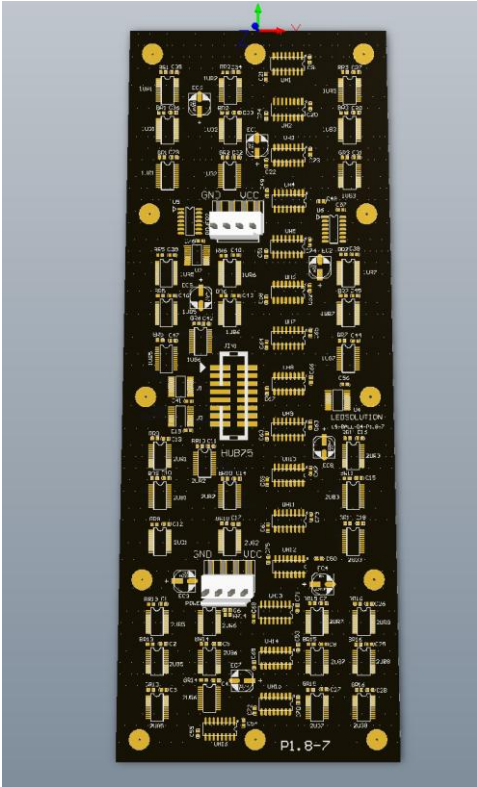

4. Cabinet & Accessories cont.

- Module-No.01

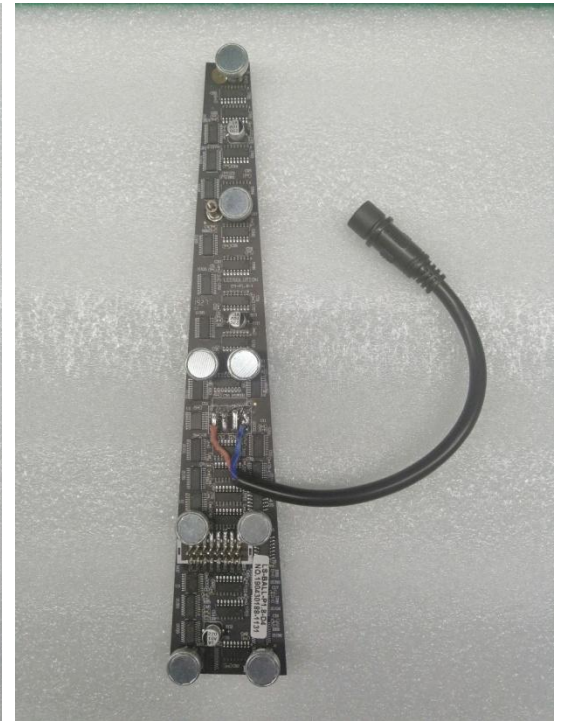

4. Cabinet & Accessories cont.

- Module-No.02

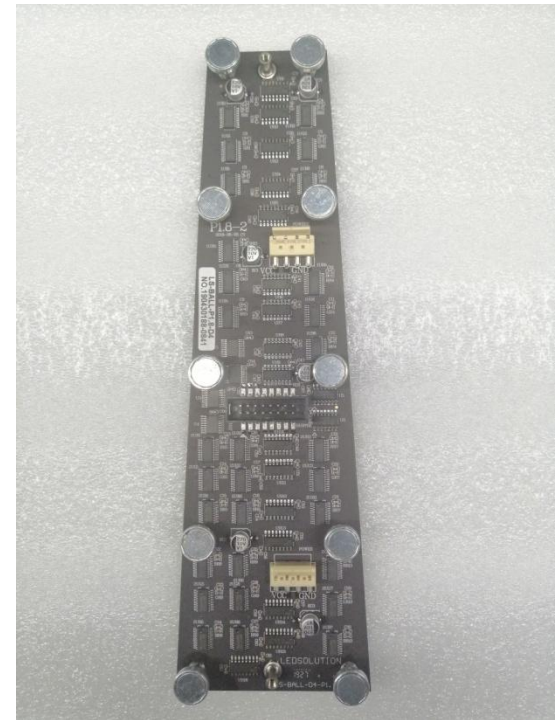
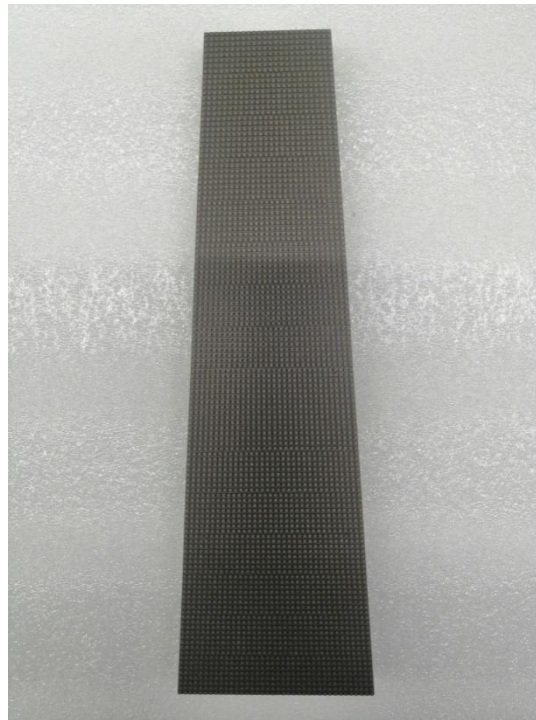
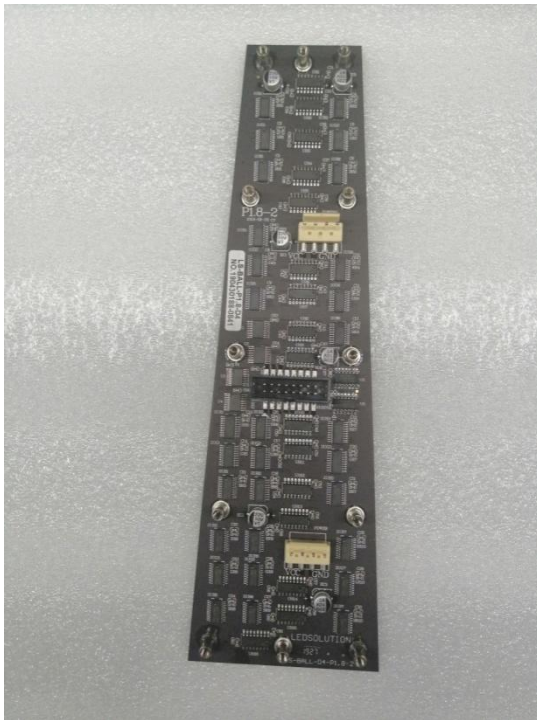

4. Cabinet & Accessories cont.

- Module-No.03

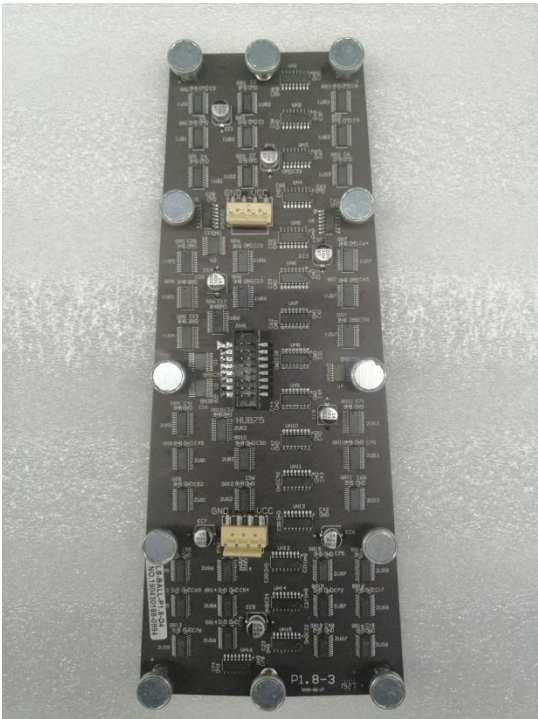
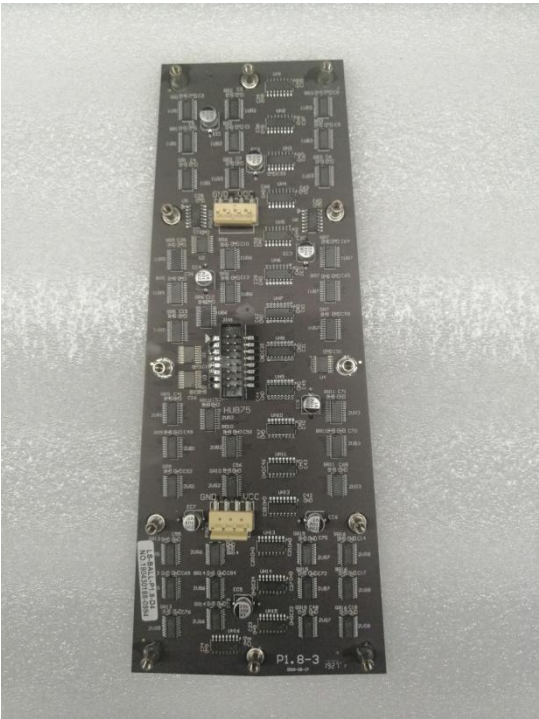

4. Cabinet & Accessories cont.

- Module-No.04

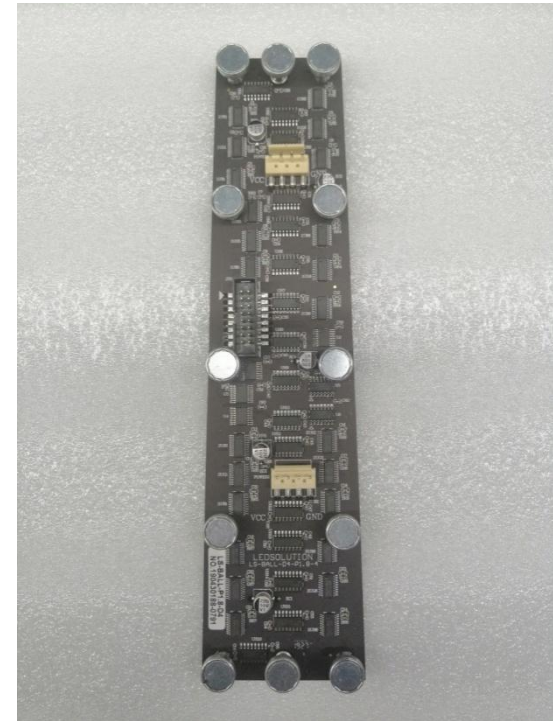
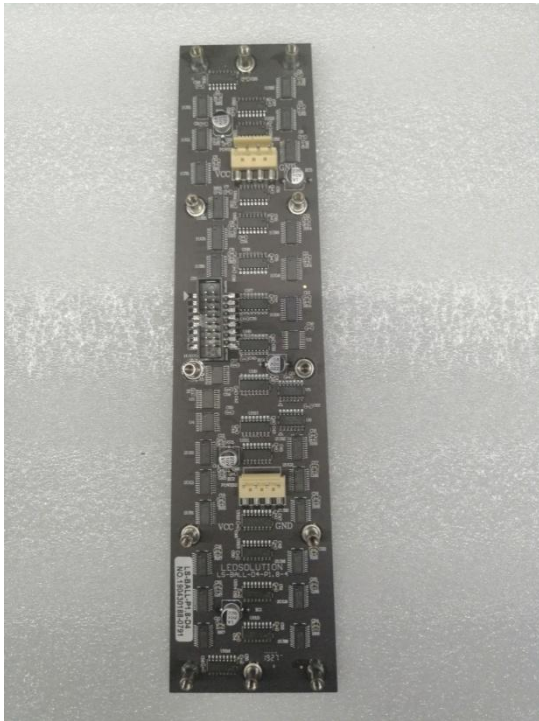

4. Cabinet & Accessories cont.

- Module-No.05

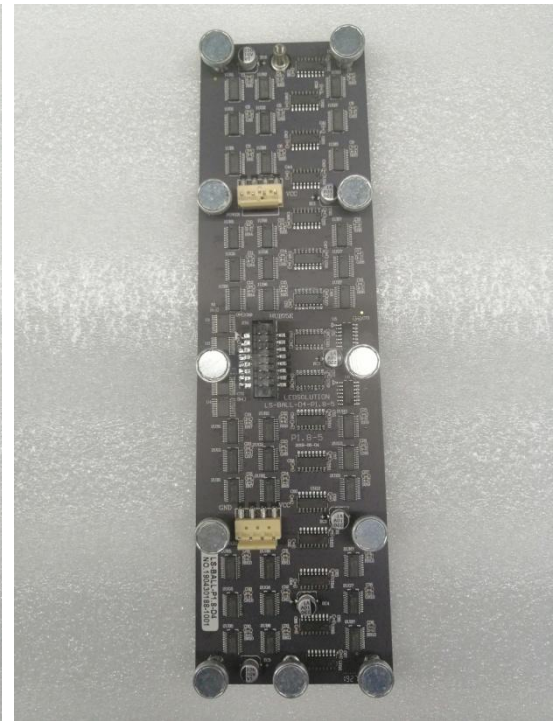
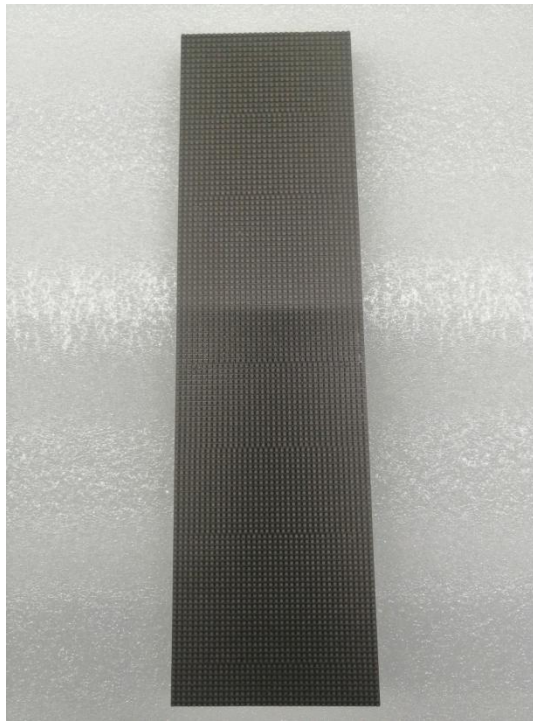
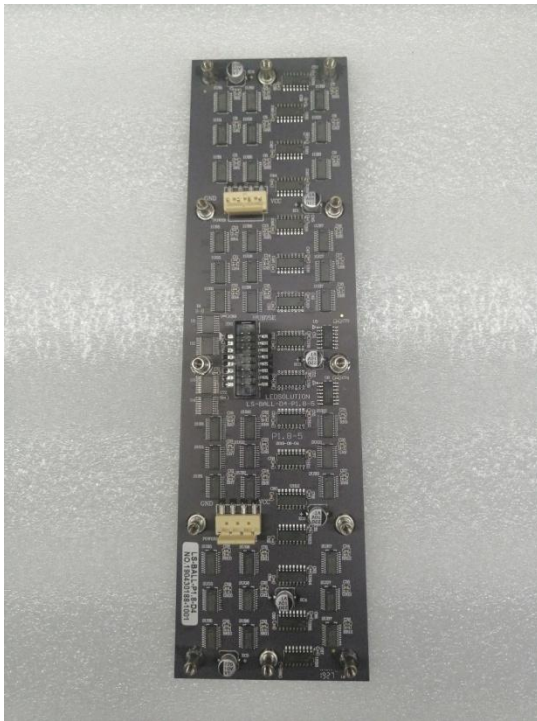

4. Cabinet & Accessories cont.

- Module-No.06

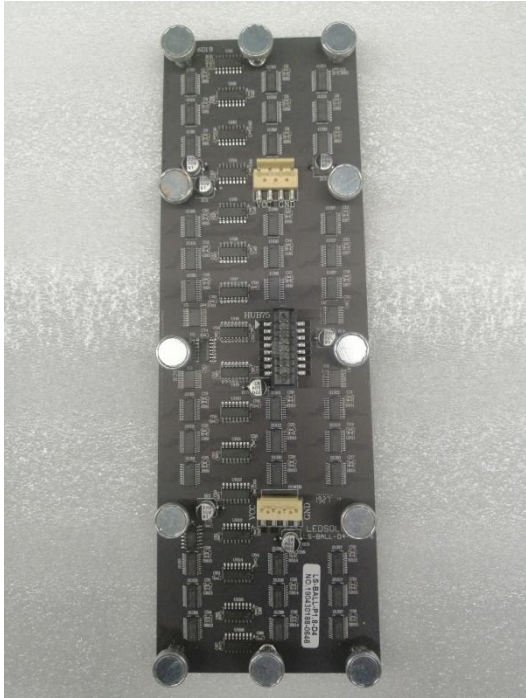
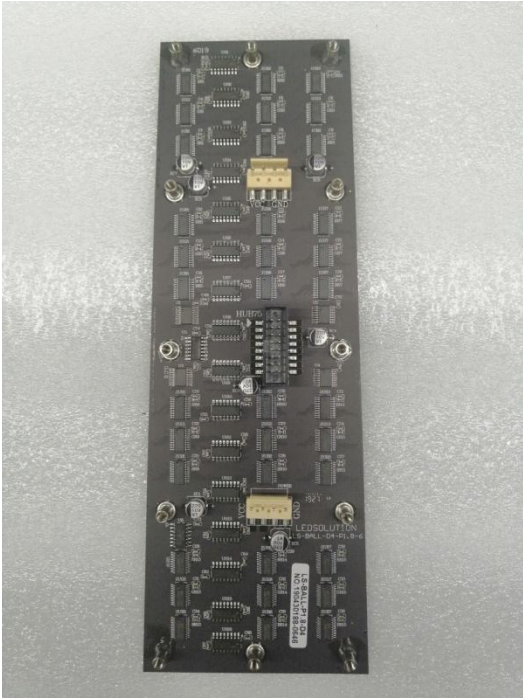

4. Cabinet & Accessories cont.

- Module-No.07

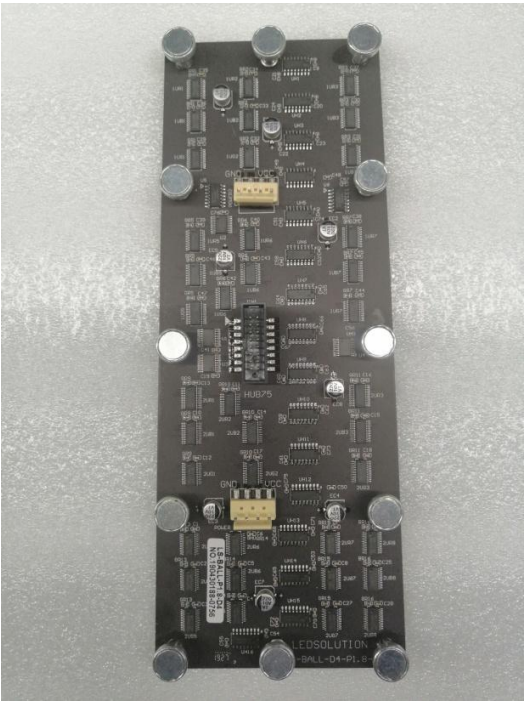
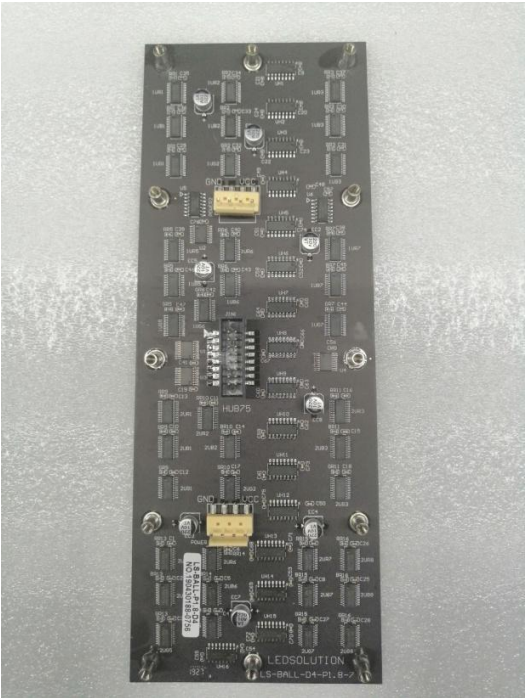

4. Cabinet & Accessories cont.

- Module-No.08

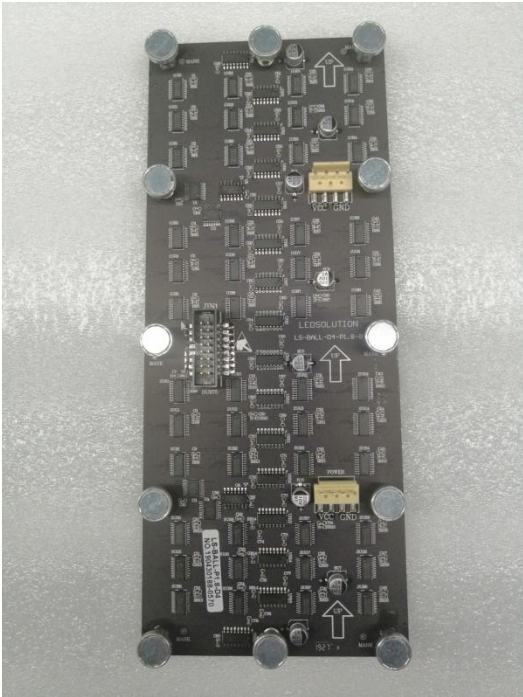
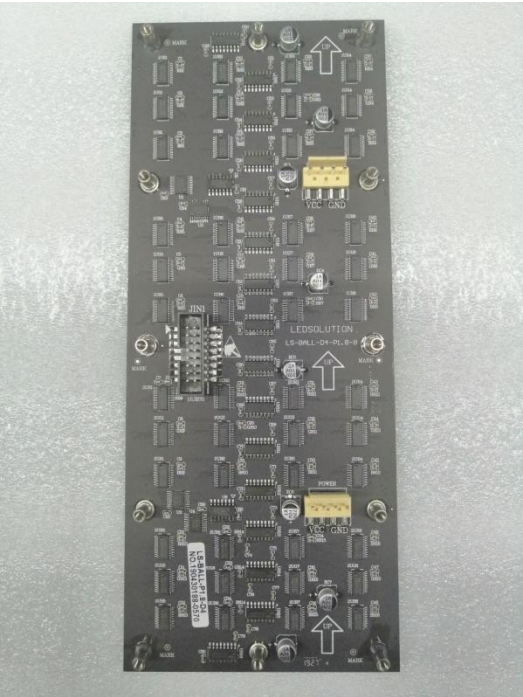

4. Cabinet & Accessories cont.

- Module-No.09

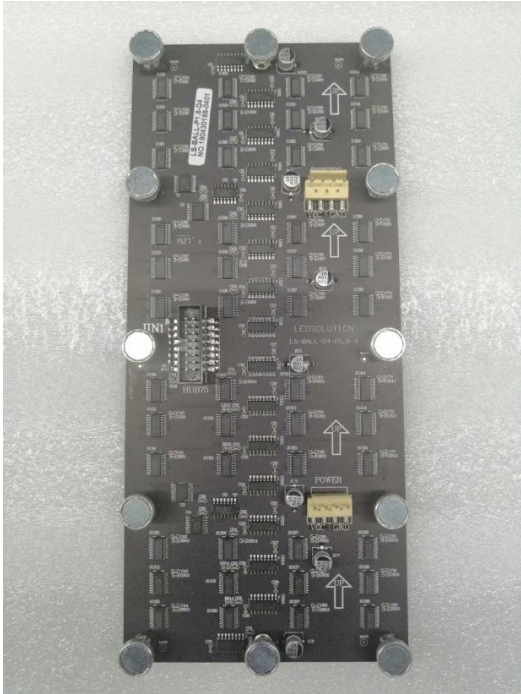
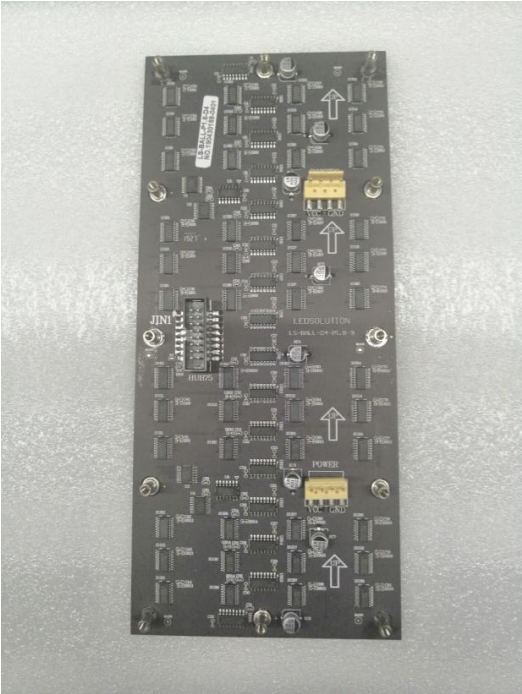

4. Cabinet & Accessories cont.

- Module-No.10

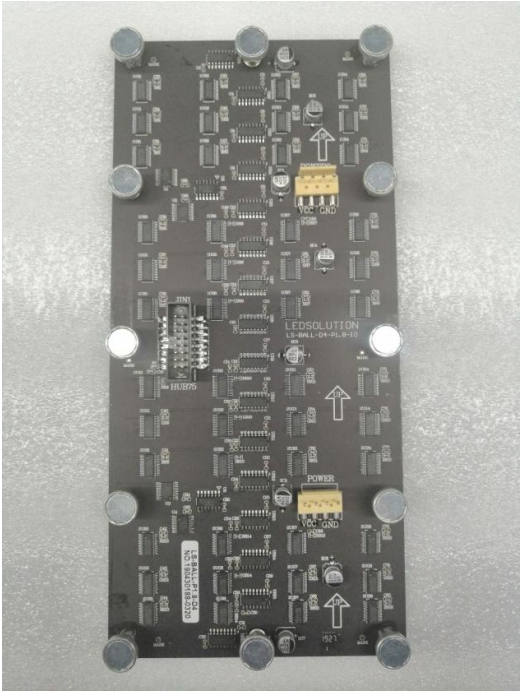
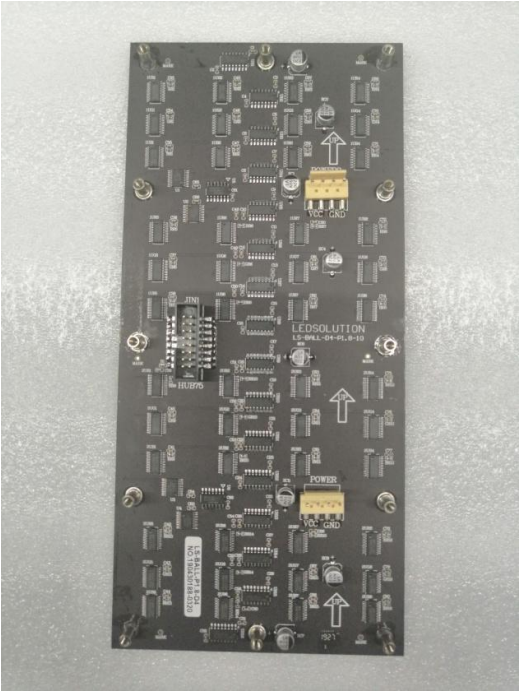

4. Cabinet & Accessories cont.

- Module-No.11

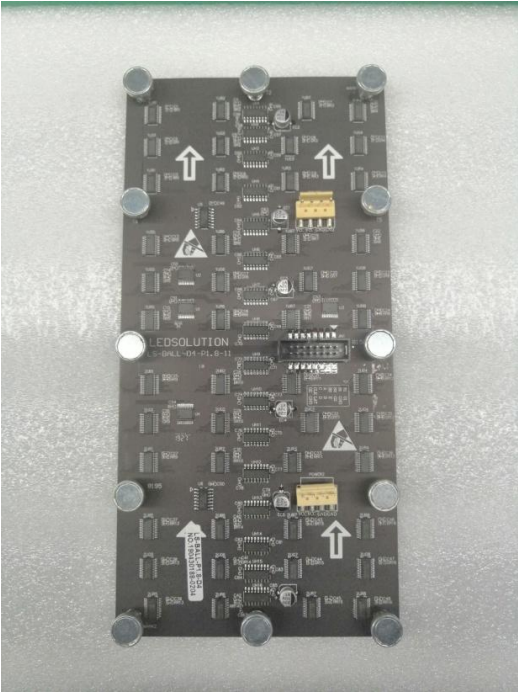
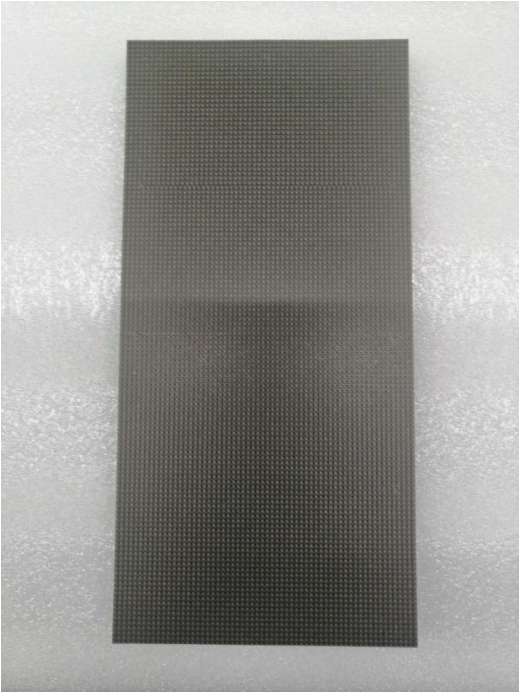
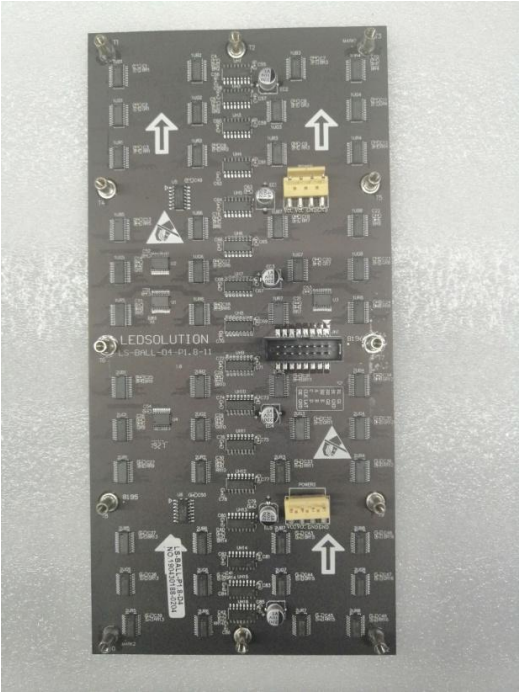

4. Cabinet & Accessories cont.

- Module-No.12

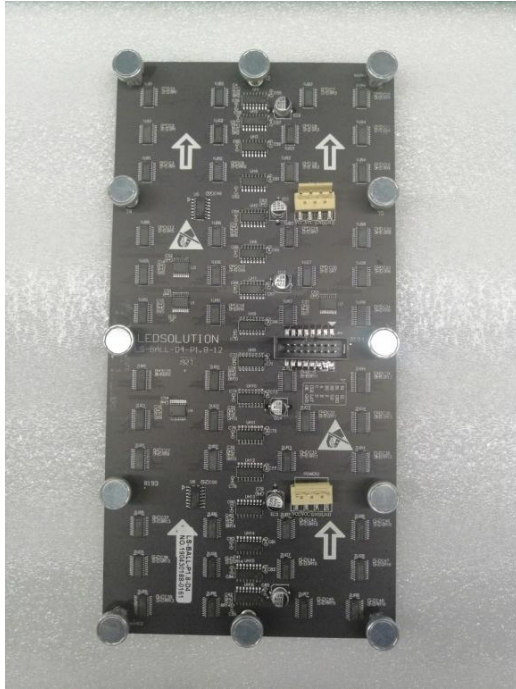
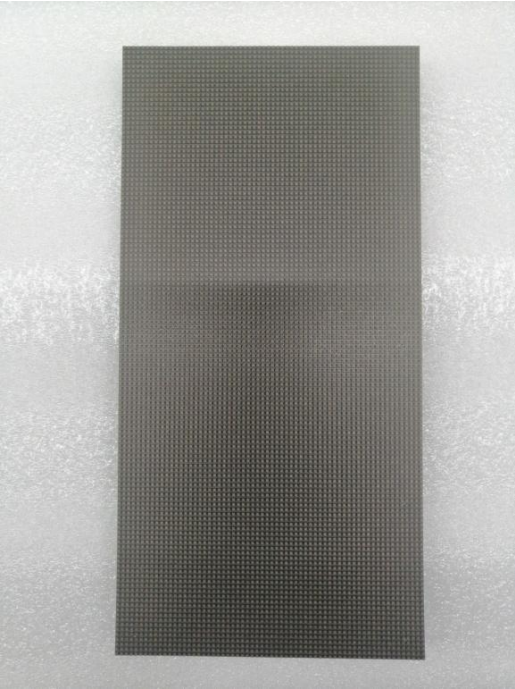
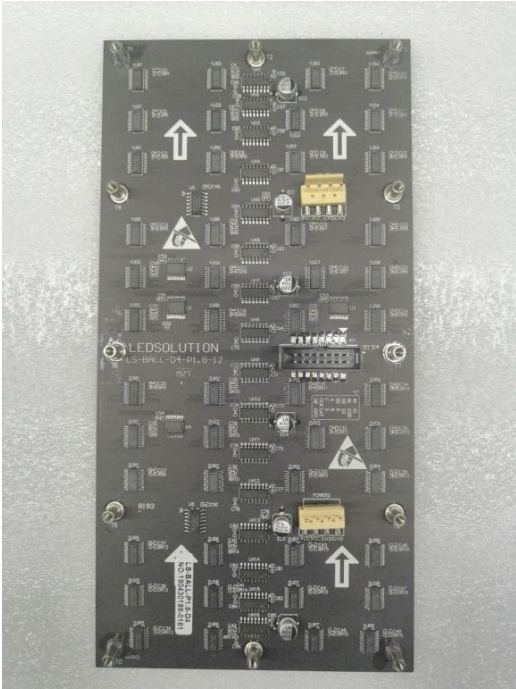

4. Cabinet & Accessories cont.

- Module-No.13

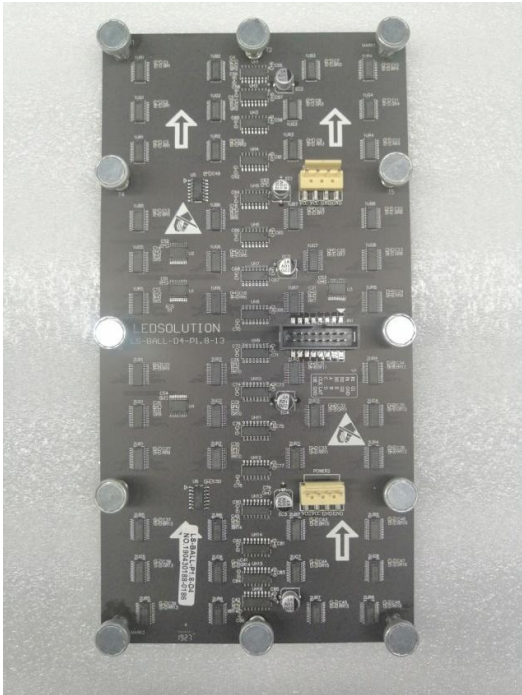
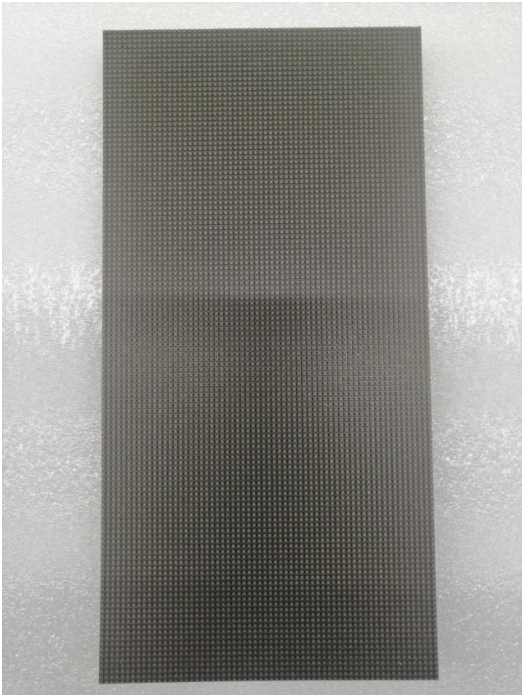
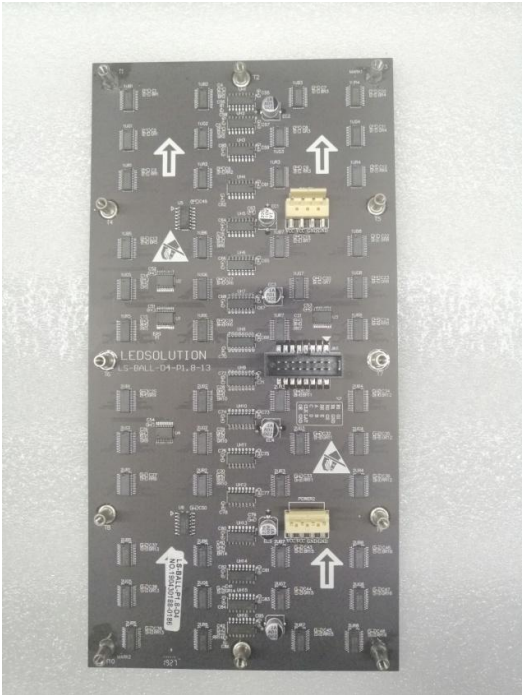

4. Cabinet & Accessories cont.

- Part of the modules assembled to cabinets



4. Cabinet & Accessories cont.

- Power supply



4. Cabinet & Accessories cont.

- Receiving card & HUB



4. Cabinet & Accessories cont.

- Mobile control rack



4. Cabinet & Accessories cont.

- PDU



4. Cabinet & Accessories cont.

- LED module packing

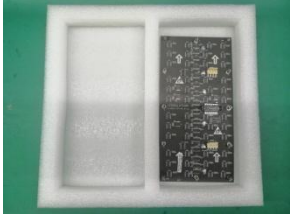
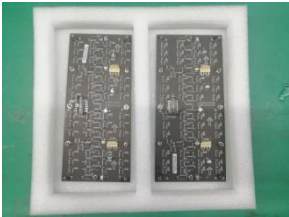
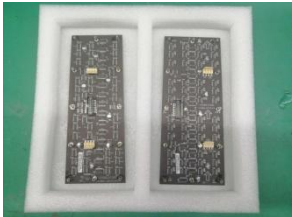
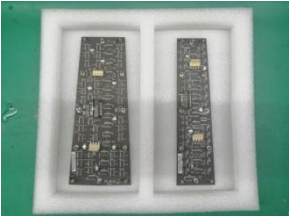

5. Packing

- Cabinet packing design

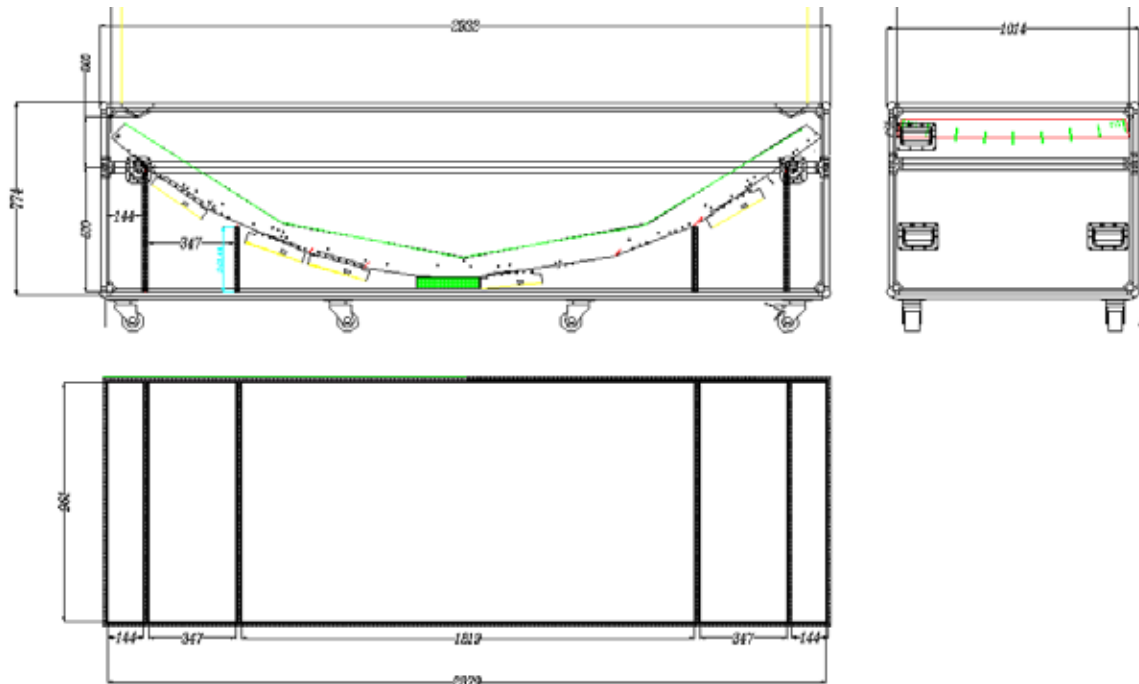

5. Packing cont.

- Flight case for cabinet



5. Packing cont.

- Installation structure packing design

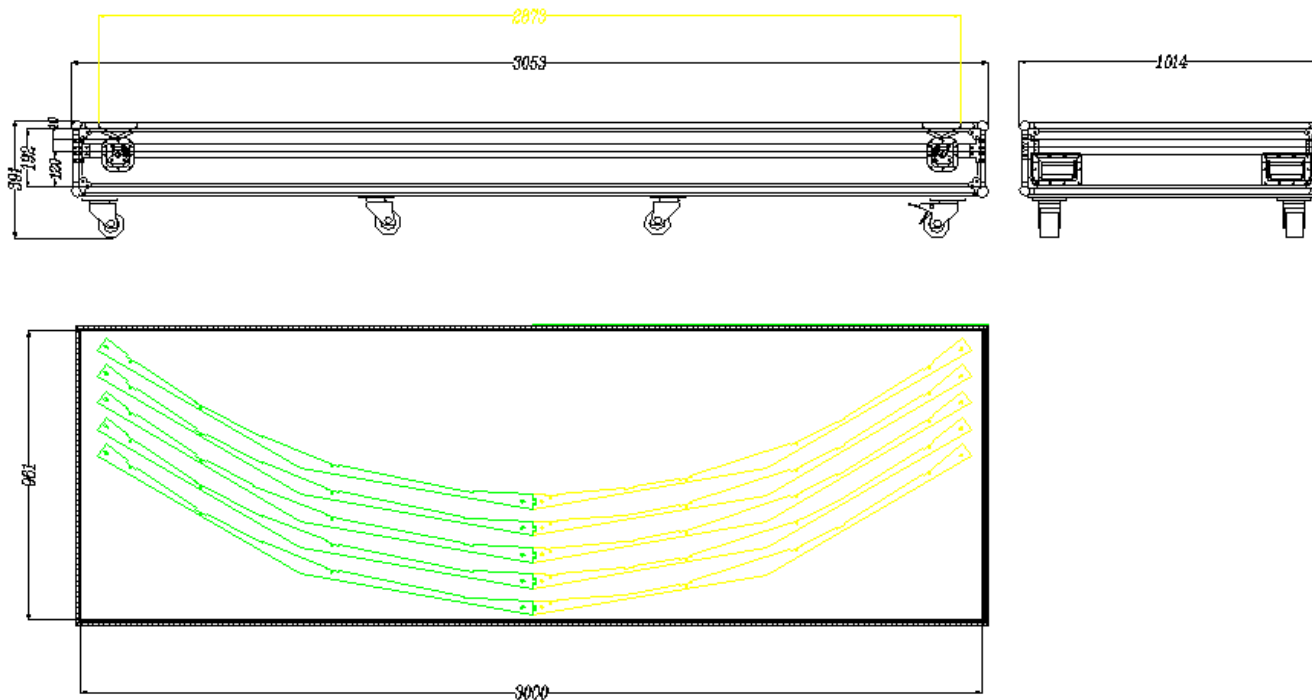

5. Packing cont.

- Flight case for installation structure



5. Packing cont.

- Spare parts & accessories packing design

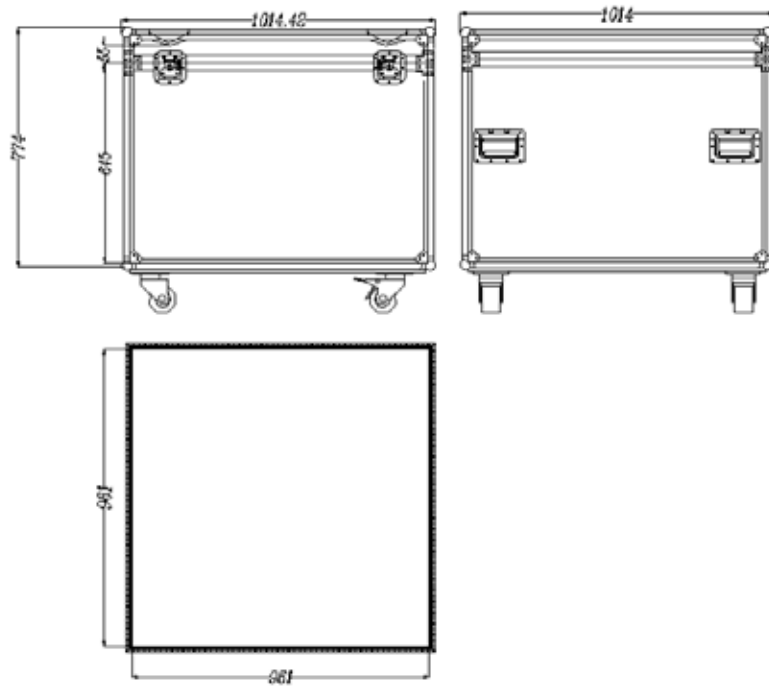

5. Photos of the package

- Flight case for spare parts & accessories



5. Packing

- Loading to a 40GP container

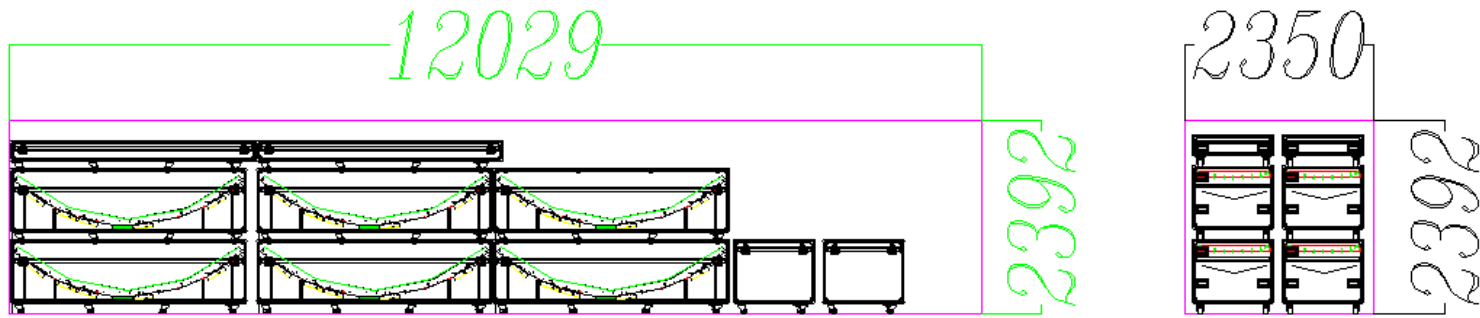

6. Installation Precautions

- Installation steps

1. Consider whether to elevate the LED dome suggest to elevate 0.7m to 1.2m.
2. Measure the installation site and define the center point.
3. Firstly install the 5pcs iron plates at the bottom. The iron plates are numbered. Please assemble them according to the numbers, and make sure they are evenly and tightly connected.

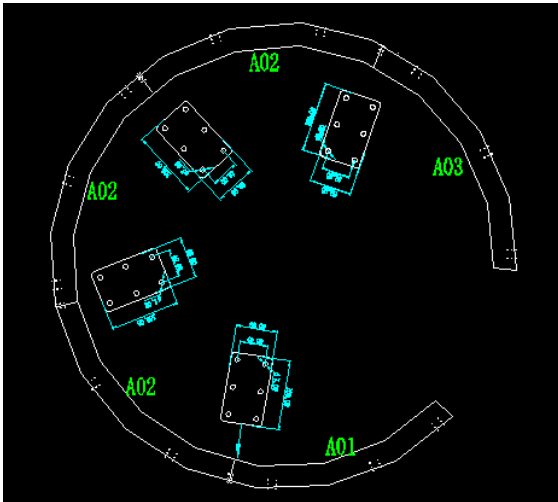

6. Installation Precautions cont.

4. Assemble the installation structure upon the center point. Brace or pull the circle structure at the top.
5. Find No.01, No.07, No.13 vertical beam. Assemble them in order to the bottom iron plates and the top circle frame.
6. Measure again and confirm the diagonal distance between the bottom iron plates.
7. Assemble the vertical beams No.02, 03, 04, 05, 06, 08, 09, 10, 11, 12 in order.
8. Assemble the horizontal beams, from bottom to top. Please note there is one set of beams with different length to others.
9. Assemble the cabinets from 1 to 12. We need to use modules to help locate the position between two cabinets, and bottom and top of the cabinets.
10. Assemble the modules that were dismantled from the cabinets, after all cabinets are assembled.
11. Connect power cables and signal cables.
12. Power on and test.

6. Installation Precautions cont.

- Important notices

1. The base for installing the dome should be flat. Make sure the bottom iron plates are on the same horizontal level after assembled.
2. Assemble the parts according to correct order. Follow the number marks strictly.
3. When taking a cabinet out of the flight case, there should be 4 people to take care of it, and handle it gently to avoid damage. Move the cabinets evenly to avoid distortion.
4. When assembling the installation structure, at first, do not fix the screws tightly, in case adjustments are needed finally.
5. The LED modules should not be hit or bumped by any other objects or tool.
6. When a module needs to be removed and re-assembled, the operator should follow Elport Digital's instruction.
7. Electrostatic wrist strap should be worn if assembling the module in Winter. If you wear gloves, it should use thin cotton gloves.

6. Installation Precautions cont.

- Important notices

8. After the modules are dismantled and re-assembled, there will be some malfunctions, it's inevitable to small pitch displays like P1.8mm.

9. H2 processor inputs are 2 x HDMI1.3 (3840x2160 30HZ). Recommend to use NVIDIA graphic card. If using another model, it has to be set to HDMI1.3 (3840x2160 30HZ) mode.



10. Do not unplug the HDMI or DVI cables when the processor and MCTRL600 are still powered on.

11. After the LED dome work for a period of time, there will be some heat inside it. Assemble air conditioner when necessary.

12. We suggest to allow at most 5 people standing and watching inside the LED dome at the same time.